

# OUTDOOR ADVENTURE EXPO

## U of M Stages and Films

One to 3 blocks. Follow signs. 

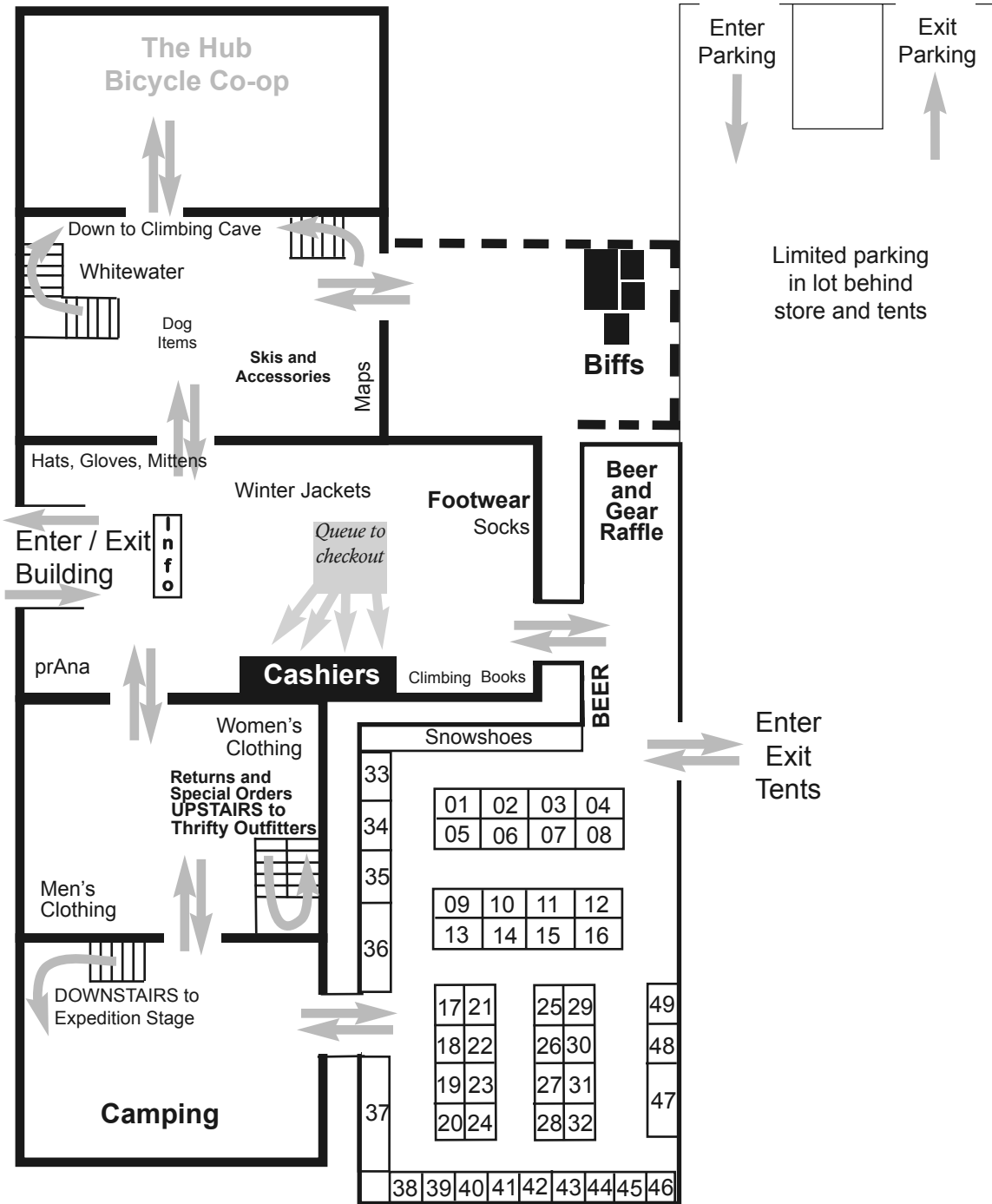

### Exhibitors with booths

- | BOOTH | EXHIBITOR  |
|-------|--|
| 35    | Access to Tanzania                               |
| 45    | American Alpine Club                             |
| 18    | Bearskin Lodge                                   |
| 16    | Body Mind Chiropractic                           |
| 39    | Border Route Trail Association                   |
| 33    | Borton Overseas, Journeys to Extraordinary Lands |
| 42    | Boundary Waters Advisory Committee               |
| 25    | Camp Manito-wish YMCA                            |
| 14    | Center for Outdoor Adventure, U of M             |
| 36    | Cooke Custom Sewing                              |
| 07    | Costa Rica Authentic                             |
| 08    | Destination Tanzania                             |
| 10    | Far and High Adventure Travel                    |
| 04    | Friends of the Boundary Waters                   |
| 46    | Friends of the Kinni                             |
| 30    | Gaard One  |
| 20    | HI-Mississippi Headwaters Hostel                 |
| 41    | Ice Age Trail Alliance                           |
| 48    | John Beargrease Sled Dog Marathon                |
| 13    | KB Tambo Travel                                  |
| 09    | Knowmad Adventures                               |
| 29    | Leisure Hotels and Resorts                       |
| 22    | Loppet Foundation                                |
| 01    | Midwest Outdoor Resorts                          |
| 47    | Midwest Popcorn Booth                            |
| 44    | Minnesota Climbers Association                   |
| 27    | Minneapolis Park and Recreation Board            |
| 31    | Minnesota Rovers                                 |
| 12    | Namaste Treks & Expeditions                      |
| 34    | New View Adventures                              |
| 38    | North Country Trail Association                  |
| 19    | Northern Lakes Canoe Base                        |
| 26    | Parks and Trails Council of Minnesota            |
| 15    | Play Clean Go                                    |
| 45    | Popcorn  |
| 05    | Right Path Adventures                            |
| 23    | Save The Boundary Waters                         |
| 02    | Skipulk.com                                      |
| 37    | Sloth and Fox Outdoor Company                    |
| 32    | Superior Highland Backcountry                    |
| 40    | Superior Hiking Trail Association                |
| 21    | Three Rivers Park District                       |
| 06    | Thrive Adventures                                |
| 17    | Visit Cook County                                |
| 49    | Visit Duluth                                     |
| 24    | VOBS   |
| 43    | Water Legacy                                     |
| 11    | Wild Wales                                       |
| 03    | Yellowstone Expeditions                          |
| 28    | YMCA of the Twin Cities                          |

# November 16-18 2018

## Presentation Schedule Opposite Side

To view presentation descriptions on your smart-phone go to [OutdoorAdventureExpo.com](http://OutdoorAdventureExpo.com).